

ALL FIELDS DETAIL



MLS # 206000
Class LOTS/LAND
Type Residential Lot < 1 Acre
Area DECATUR CO.
Asking Price \$7,500
Address 0 Bill Perry Drive
Address 2
City Sugar Tree
State TN
Zip 38380
Status Active
Sale/Rent For Sale
IDX Include Y
Picture Count 5

Term For Sale
City Limits No
Waterfront No
Waterview Yes



GENERAL

Special School Tax	\$0	Number of Acres	0.35
Map #	036A	Group	A
Parcel #	004.00 & 004.01	Agent	Lee W Godfrey - Cell: 731-343-2900
Listing Office 1	Coldwell Banker Barnes - Main: 731-668-1777	ListAgent Cell Phone	731-343-2900
List Agent Email	lee@leegodfrey.com	List Team	Lee Godfrey Team
Listing Agent 2		Listing Office 2	
ListAgent 2 Cell Phone		ListAgent 2 Email	
Compensation Offered	\$500	Dual/Variable Rate (Y/N)	Yes
Listing Type	Exclusive Right	Owner/Agent (Y/N)	No
Size	100x150	Wooded Acres	0
Pasture Acres	0	Tillable Acres	0
Listing Date	3/10/2021	Road Frontage	100
County	DECATUR COUNTY	Subdivision	WOODLAWN SHORES
Zoned Historical (Y/N)	No	Covenants (Y/N)	Yes
Will Divide (Y/N)	No	Greenbelt (Y/N)	No
Will Subdivide (Y/N)	No	Subdivide Breakout	
Income		Zone	COUNTY FR
Legal		Off Market Date	
Search By Map		Lender Req Proof of Funds	Yes
Tax ID		Update Date	3/10/2021
Status Date	3/10/2021	HotSheet Date	3/10/2021
Price Date	3/10/2021	Input Date	3/10/2021 2:10 PM
VOW Address	Yes	VOW Include	Yes
Associated Document Count	3	VOW Comment	Yes
VOW AVM	Yes	Agent Hit Count	0
Client Hit Count	0	Original Price	\$7,500
Loan Type		SentriLock being Used	No
SentriLock Serial Number		Geocode Quality	
Sold Price Per SQFT		Associated Staff Amendments	
Input Date	3/10/2021 2:10 PM	Update Date	3/10/2021 2:10 PM
Deed		Page #	

FEATURES

ACCESS ROAD Paved	LOT DESCRIPTION Heavy Wooded	PROPERTY USE Vacant	TERMS Cash
AVAILABLE UTILITIES Electricity	POSSESSION At Closing	ROAD MAINTAINED BY County	TOPOGRAPHY Gentle Rolling

FINANCIAL

Financing Terms	Cash	Syndication Remarks	2 Lots (8 & 9) in Woodlawn Shores with Winter Water View. Lots Front on Bill Perry Drive & Divider Lane. 100 Yards to Boat Ramp.
Type of Sale	Normal Sale	Taxes - City	0.00
Taxes - County	100.00		

SOLD STATUS

How Sold
Closing Date
Selling Agent 1
Sell Team
Legal Sellers Name Gloria Johnson
Home Warranty (Y/N)

Contract Date
Sold Price
Selling Office 1
Seller Concessions
Additional Comments

DIRECTIONS

Directions Take I-40 to Exit 126, Go South Towards Parsons for 5.9 miles, Left on Old Highway 69 for 4.2 miles (When you turn off Hwy 69 & Travel 8/10 mile, Go Straight Ahead, Old Hwy 69 Turns into Bohannon Landing Road then turns into Cherokee Heights Road) Turn Left on Oak Park Drive for 3/10 mile, Turn Left on Divider Drive for 1/10 mile. Lots on Left

PUBLIC REMARKS

Brochure Comments 2 Lots (8 & 9) in Woodlawn Shores with Winter Water View. Lots Front on Bill Perry Drive & Divider Lane. 100 Yards to Boat Ramp.

AGENT ONLY REMARKS

Agent Only Remarks Seller requests prequalification letter with all offers.

ADDENDUM

Addendum

ADDITIONAL PICTURES

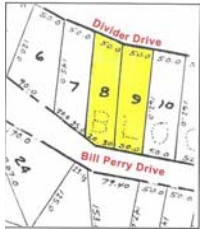

DISCLAIMER

This information is deemed reliable, but not guaranteed. Copyright CWTAR, MLS Inc. 2019